

User Manual

For customer enquiries please contact:

Daka Designs Limited (Listed Company on the Singapore Stock Exchange)

Wholly Owned Subsidiaries:

Daka Development Ltd.

Tel: (852) 2756 3862

Email: info@daka-designs.com

Website: www.daka-designs.com

Europe Sales Office:

Daka Europe Limited

Tel: +44 1628 478666

Email: info@dakaeurope.com



SEA-DOO® SEASCOOTER™

Model no. : ZS01

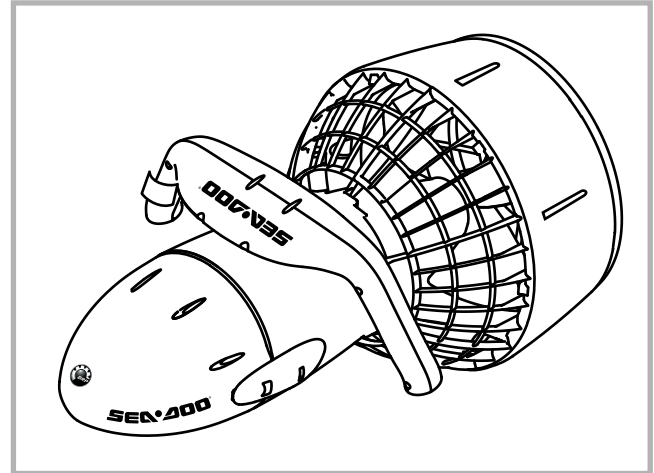

SEA-DOO® and BRP logo are trademarks of Bombardier Recreational Products Inc. or its affiliates, used under license to Daka Development Ltd. For more information on SEA-DOO® products visit www.seadoo.com



www.daka-designs.com

© 2005 Daka Development Ltd. All rights reserved.

Design Registered • Patent Pending

Printed in China



CAUTION
ELECTRICALLY OPERATED PRODUCT

Recommended for ages 16 years and up.

As with all electrical products, precautions should be observed during handling and used to reduce the risk of electric shock.

Contents

Introduction

①

Parts diagram

②

WARNING

③

Getting started

⑤

Battery use

⑨

Care & Maintenance

⑩⑥

Trouble Shooting

⑩⑧

Introduction

Thank you for having chosen the SEA-DOO® SEASCOOTER™ - with the SEASCOOTER™ swimming, snorkeling and diving is effortless and fun.

Years of design and engineering have resulted in a personal water propeller that gives you power - up to 2 mph/3km/h for up to 40 minutes of use with a standard battery - but at the same time is compact and light.

There are many features incorporated in this sophisticated design, please take a little time to study the manual to learn about them all to get the most out of your SEASCOOTER™.

Parts Diagram

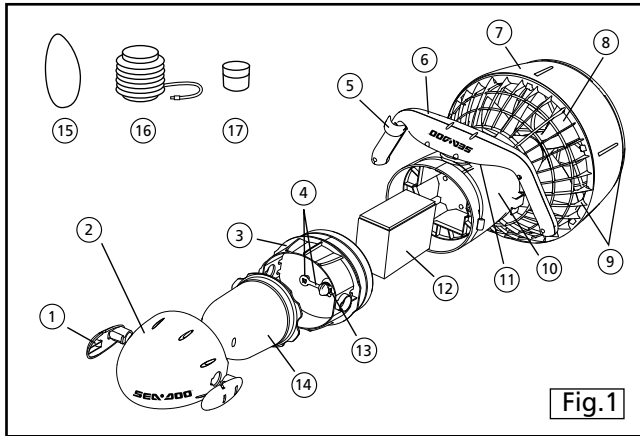

Fig.1

- | | |
|----------------------|----------------------------|
| ① Latch | ⑩ Battery Housing |
| ② Nose Cone | ⑪ Master Switch |
| ③ Inner Nose Cone | ⑫ Battery |
| ④ Vent Plug | ⑬ Vent Hole |
| ⑤ Trigger | ⑭ Buoyancy Control Chamber |
| ⑥ Handle | ⑮ Silicone Ring |
| ⑦ Nozzle | ⑯ Pump |
| ⑧ Propeller | ⑰ Lubricant |
| ⑨ Protective Grilles | |

②

⚠ WARNING

- Read the User Manual carefully.
- Never remove the grilles except for maintenance.
- Never stick body parts, clothing or other objects in the vicinity of the Propeller. Do not wear loose or flowing clothing or equipment that could be drawn into the Propeller.
- Particular care should be exercised when using the SEASCOOTER™ near anybody with long hair. Users with long hair should tie it up or wear a swimming cap when using the SEASCOOTER™.
- Always inspect the swimming area to ensure it is free of hazards or obstacles such as boats and swimmers before using the SEASCOOTER™.
- Always charge battery to its fullest before using the SEASCOOTER™. Ensure sufficient battery charge remains for return to shore or surface.
- Always wear a coast guard approved personal flotation device when using the SEASCOOTER™.
- Be aware of appropriate water levels, tidal changes, dangerous currents, weather changes and strong offshore winds. Always scout unfamiliar water.
- Do not use alcohol or mind-altering drugs prior to using this product.

③

Getting Started

- ALWAYS keep the SEA-DOO® SEASCOOTER™ out of direct sunlight when not in use. HEAT KILLS BATTERIES.
- When using the SEA-DOO® SEASCOOTER™ for SCUBA, ascents and descents should be made in accordance with recognized diving practices.
- The SEA-DOO® SEASCOOTER™ should only be used for SCUBA by qualified divers.
- Always follow this age recommendation: a child under 16 years old should never operate this SEA-DOO® SEASCOOTER™.
- Never open the Cover of the SEA-DOO® SEASCOOTER™ in the water.
- When not in use, always turn the Master Switch to the off position.
- Do not use the SEASCOOTER™ below the recommended maximum depth of 65ft/20m.

When you buy the SEA-DOO® SEASCOOTER™ the battery is disconnected and needs to be charged, follow the instructions on page 9, Battery Use, Charging the Battery, for charging and connection.

Using the SEASCOOTER™ for swimming and snorkeling.

When swimming or snorkelling the SEA-DOO® SEASCOOTER™ should be kept positively buoyant - this is done by simply making sure the Buoyancy Chamber is empty and fitted inside the Nose Cone.

To use the SEASCOOTER™ for swimming or snorkeling follow these instructions.

1. Charge the battery - see page 9 for instructions (make sure that when you finish charging the Vent Plug is closed).
2. Place the SEA-DOO® SEASCOOTER™ into the water so the Handle, Outer Nose Cone and Nozzle fill with water.
3. When ready to set off, switch the Master Switch to the On position shown in figure 2.
4. Pull and hold the Trigger to start the Propeller. (There is a short delay before the Propeller begins to rotate).
5. To stop the Propeller, simply release the Trigger.
6. Always turn the Master Switch off when out of the water.

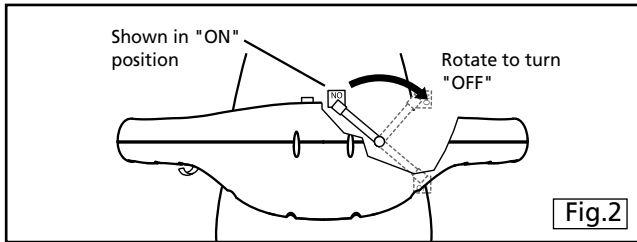

7. Proper posture when using the SEA-DOO® SEASCOOTER™ is important to achieve the maximum speed - see figure 3 for the correct position of the SEA-DOO® SEASCOOTER™ when using it.

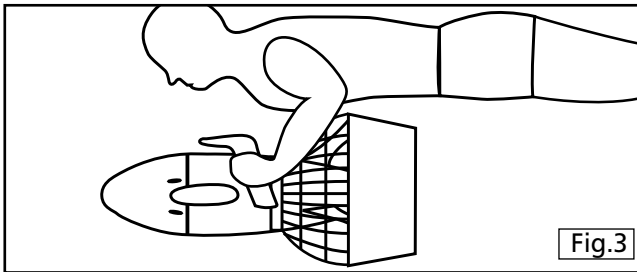

CAUTION

Do not dive deeper than you would normally when snorkeling, to ensure you can get back to the surface safely.

Using the SEA-DOO® SEASCOOTER™ for diving - adjusting the buoyancy.

Your SEASCOOTER™ can be used for diving up to 65ft/20m but will need to be adjusted for neutral buoyancy. The SEASCOOTER™ must never be adjusted for negative buoyancy to avoid it sinking if accidentally released.

To adjust for neutral buoyancy follow these instructions

1. Make sure the SEA-DOO® SEASCOOTER™ is in the "OFF" position.
2. Remove the SEASCOOTER™ from the water, give a half turn to the Latches, remove them (see figure 4) and remove the Buoyancy Control Chamber.

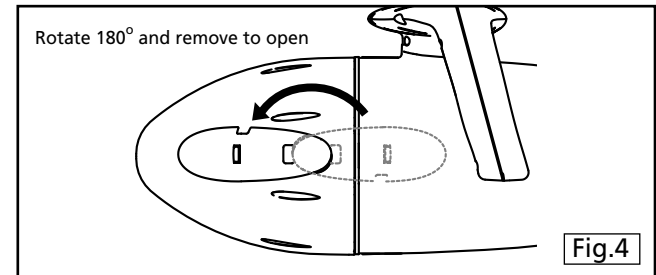

3. Replace the Outer Nose Cone and Latches.
4. Place the SEA-DOO® SEASCOOTER™ in the water to fill the Nozzle, Handle and Outer Nose Cone with water.

5. Remove the lid form the Buoyancy Control Chamber and place the upturned chamber on the Handle as show in figure 5.

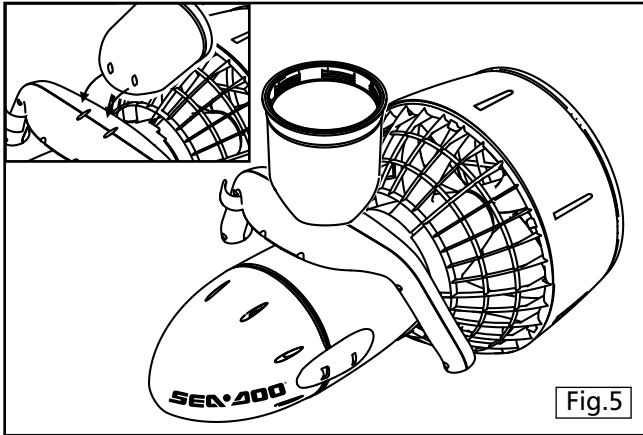

6. Adjust the buoyancy by adding stones and replace the lid of the Buoyancy Chamber making sure the seal is free from sand.
7. Remove the SEASCOOTER™ from the water, remove the Outer Nose Cone again, replace the Buoyancy Chamber, replace the Outer Nose Cone and close with the Latches.

CAUTION

If the SEASCOOTER™ is later used for swimming or snorkeling be sure to remove the weight from the Buoyancy Chamber so the SEA-DOO® SEASCOOTER™ has positive buoyancy.

CAUTION

- The Battery Housing should always be ventilated during charging to allow potentially explosive gasses to dissipate. Before removing/attaching any battery cables always allow two minutes for any gasses to dissipate.
- ALWAYS plug the charger jack into the charging socket first and then plug into the mains. When charging is complete, unplug the charger from the mains first and then from the charging socket.
- ALWAYS ensure the charger is DRY before plugging it into a live socket.
- NEVER place the battery in a sealed container when charging.
- Never charge battery near water.
- If in doubt of the state of the battery, recharge it until the indicator on the battery charger flashes indicating a full charge.
- ALWAYS charge battery in a well-ventilated place where unit is out of reach of children.
- ALWAYS ensure the unit is dried thoroughly before opening the Nose Cone for charging or changing the battery.
- ALWAYS charge the battery fully to ensure long battery life.
- For periods of prolonged non-use recharge battery periodically to keep it fully charged and ensure long battery life

Charging the battery

For battery charging follow these instructions.

1. Always ensure that the Master Switch is "OFF" - see figure 2.
2. Always ensure that the SEA-DOO® SEASCOOTER™ is out of the water and placed in a dry area.
3. Give a half turn to the Latches and remove them from the Nose Cone as shown in figure 4.
4. Remove the Outer Nose Cone and Buoyancy Control Chamber.
5. Open the Vent by unscrewing the Vent Plug.
6. Remove the Inner Nose Cone. To do this, first feed the silicone ring (provided with this manual) through the latch holes in the Inner Nose Cone and hook over the hooks in the Battery Housing (see figure 6). Then screw the Pump Nozzle onto the Vent Hole and pump air into the Battery Chamber until the Inner Nose Cone pops off and then remove the silicone ring.
7. Allow two minutes for any gasses to dissipate.
8. Disconnect the battery cable from the housing cable (if not already disconnected - the cable will be disconnected when you buy your SEASCOOTER™) by pressing the locking feature, as shown in figure 7.

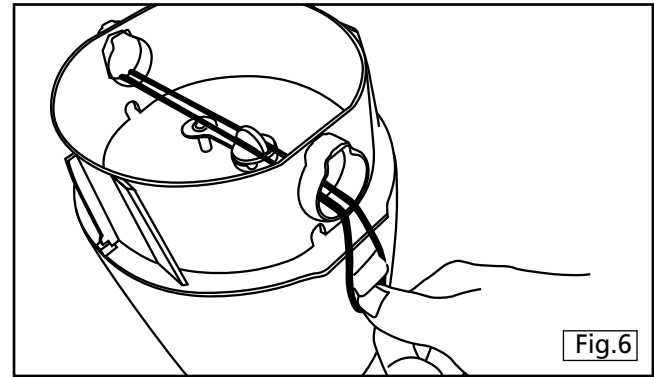

Fig.6

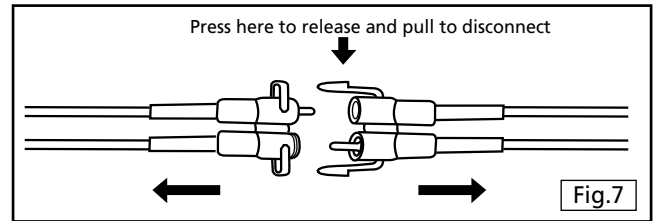
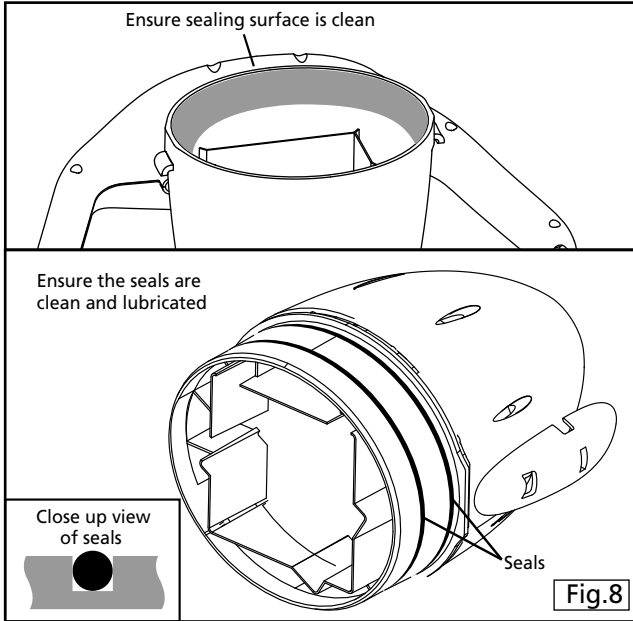

Fig.7

9. Connect the battery cable to the charger cable.
10. Plug charger into mains, and turn on the supply. Do not replace the Nose Cone.
11. Charging will take 4 to 6 hours for a fully discharged battery. Flashing light indicates battery is fully charged.
12. Unplug the adapter from the mains.
13. Unplug the battery cable from the charger cable and reconnect to the housing cable.

14. Make sure the seals and sealing surfaces are clean and lubricated before replacing the Inner Nose Cone. See figure 8.



15. Replace the Inner Nose Cone making sure the key is aligned correctly. See figure 9.
16. Ensure the Vent O Ring is fitted correctly. See figure 10.
17. Screw in the Vent Plug to seal the vent.

12

18. Replace the Buoyancy Control Chamber.

19. Replace the Outer Nose Cone making sure the key is aligned correctly and insert the Latches and lock the Nose Cone by giving them a half turn. See figure 11.

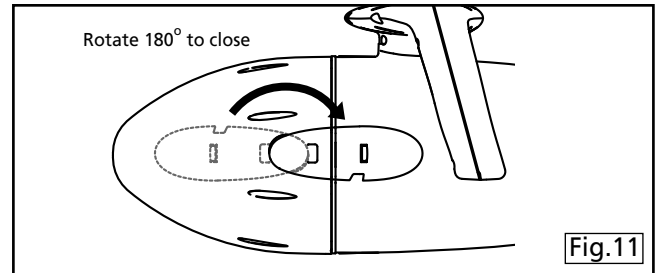
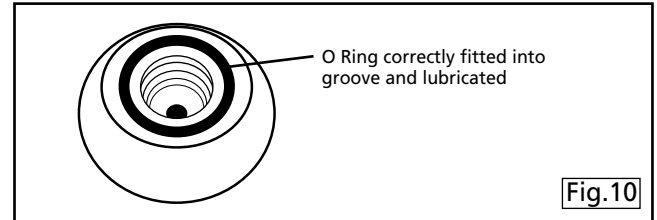
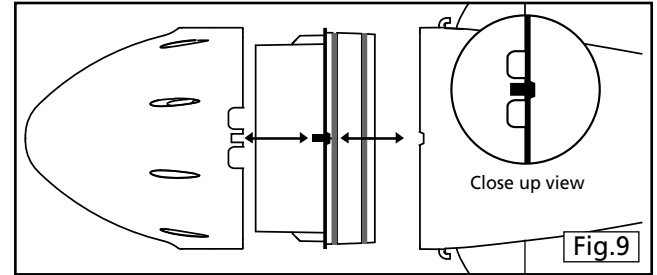

13

Note: To charge a battery outside of the unit, simply connect to the charger , then plug the charging adapter into the mains. When the battery is charged, unplug the adapter first then the battery.

To replace a flat battery with a fully charged battery.

1. Follow the steps 1 to 6 on page 10, to open the SEASCOOTER™.
2. Unplug the battery at the socket by pressing the locking feature shown in figure 7.
3. Remove the flat battery, remove the cables from the flat battery and fix them to the charged battery.
4. Install and connect the charged battery in the correct position - the leads of the standard or extended life battery must be oriented as shown on the sticker on the battery, see figure 12.

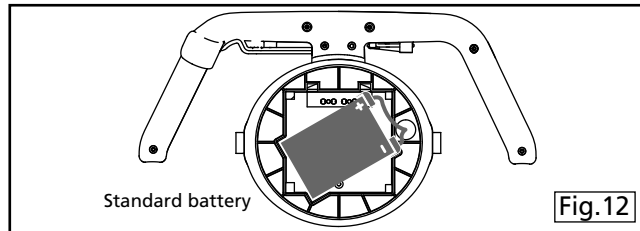

5. Follow steps 14 to 19 on page 12, to close the SEASCOOTER™.

Using the Optional Extended Life Battery.

An optional extended life battery is available through your dealer. This battery fits into the Battery Housing in a slightly different position to the normal battery, follow sticker on battery for correct orientation, see figure 13.

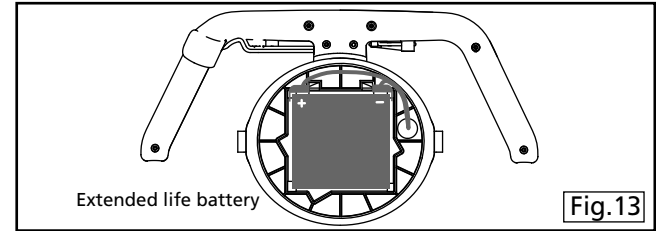

The extended battery can be charged in the same way as a standard battery.

CAUTION

Because this battery is heavier than a standard battery the Buoyancy Chamber must be added and empty to ensure the SEASCOOTER™ floats.

Buying batteries

Additional standard or extended batteries can be purchased separately. Contact your dealer to purchase them.

Care And Maintenance

Battery Care

- The battery should be recharged as soon as possible after use.
- If the unit is not used for extended periods, the battery should be removed from the unit and charged overnight every three months.
- Only use the charger supplied with the SEASCOOTER™.
- Never place the battery in a sealed container when charging.
- Never short circuit the battery or battery cable.
- Never place/store the battery near a radiator/fire, etc.
- To store the battery, remove it from the SEASCOOTER™ or separate it from the charger, insulate the battery terminals and keep in a place that is dry and cool.
- Ambient temperature for storage should be within the range -20°C to 40°C (-4°F to 104°F).

Care after using the SEASCOOTER™

- Always rinse the SEASCOOTER™ in fresh water and allow it to dry before storage.
- Whenever possible rinse the SEASCOOTER™ in fresh water immediately after use.

- To clean the SEASCOOTER™ do not use detergents, only use a damp cloth to wipe the unit clean.
- The Battery Housing interior should be kept dry at all times.
- If the Battery Housing interior ever gets wet, disconnect the battery and leave the Nose Cone off until the Battery Housing interior is dry. If the Battery Housing gets wet with seawater, disconnect the battery, drain any excess fluid dry with a towel.
- Leave the Nose Cone off until the Battery Housing interior is completely dry.
- When storing the SEASCOOTER™ for extended periods of time, open the Vent Plug in the Inner Nose Cone.
- ALWAYS store your SEASCOOTER™ vertically when not in use to prevent deformation of the Propeller Nozzle.

Trouble Shooting

Blocked Propeller

If the Propeller becomes blocked first try and remove the obstruction by removing the front grille. If this is not possible the back grille and Propeller can be removed.

Under normal use the grilles must not be removed.

Removing the front grille to remove an obstruction.

1. Remove the SEASCOOTER™ from the water.
2. Make sure the master switch is in the "OFF" position.
3. Insert a screw driver as shown in figure 14 to remove the two grille pins.

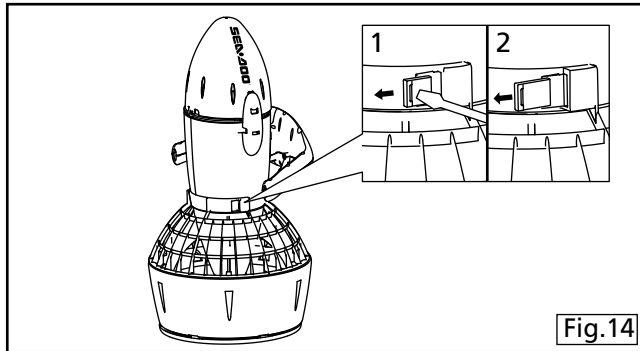

4. Unclip grille as shown in figure 15.
5. Remove obstruction.

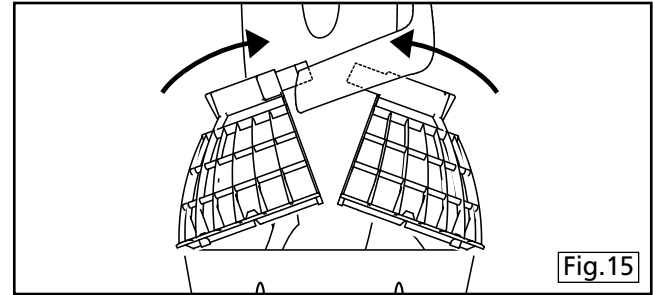

6. Reassemble grille and insert clips.

Removing rear grille and Propeller to remove obstruction

1. Remove the SEASCOOTER™ from the water.
2. Make sure the master switch is off.
3. Remove the battery.
4. Unscrew the six rear grille screws as shown in figure 16.

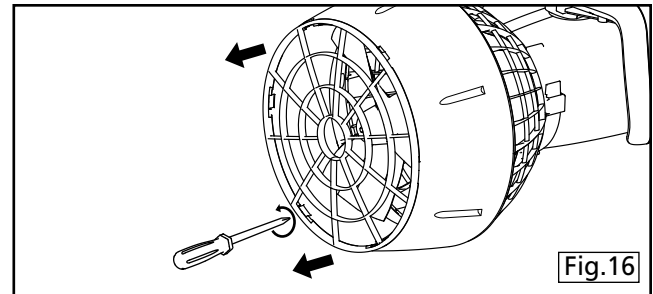

5. Whilst holding the Propeller, use an M6 socket to remove the nut from the Propeller shaft (See figure 17).

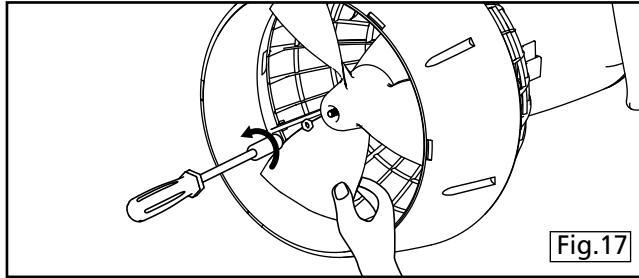

6. Slide the Propeller off the shaft, taking care not to loose the drive pin or washers.
7. Remove the blockage from the Propeller.
8. Replace the drive pin (if removed), see figure 18, and Propeller. Turn the Propeller slowly until you locate the pin and push the Propeller fully on.

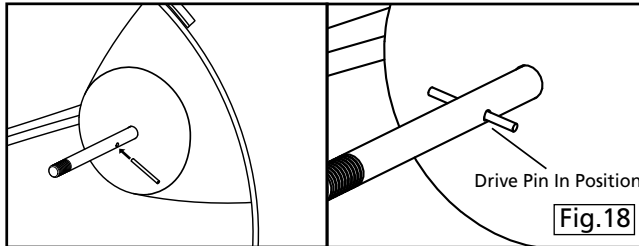

9. Replace the washer(s) and nut and tighten with the socket whilst holding the Propeller making sure it is securely fastened (See figure 19).
10. Replace the grille.
11. Replace the battery.

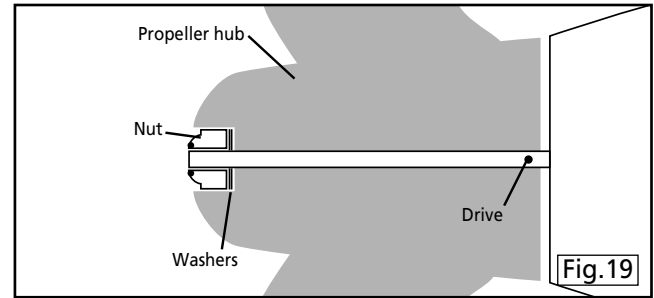

Sand or Grit on Seals

Sand or grit is the enemy of seals. Correct maintenance and care is essential. To remove sand or grit from the seals, rinse the seals in fresh water and apply fresh lubricant. If there is sand inside the Battery Housing, gently brush the sand from the unit taking care not to scratch the sealing surfaces.

Accidental Flooding

Be sure to keep the seals sand and grit free to ensure they keep water out and to close the vent plug after accessing the battery chamber. However, should the seals not be clean or the vent plug left open and water enter the battery chamber, your SEASCOOTER™ will not be damaged as it is designed for protection against accidental flooding. If water enters the battery chamber the SEASCOOTER™ will automatically stop functioning. If this occurs

1. Remove the unit from the water.
2. Open the battery chamber, remove the battery, and if salt water has entered rinse it out with fresh water.
3. Dry the battery chamber and battery thoroughly and reassemble, ready for use.